



1421 Pearl Street

Boulder, CO

Chris Boston, CCIM, MBA

cboston@gibbonswhite.com

(303) 586-5930

Kegan McNutt

kegan@gibbonswhite.com

(303) 586-5929

www.gibbonswhite.com



Property Info & Gallery



View Map

Pearl Street Retail Space For Lease

Available Space	5,743 sq. ft.
Lease Rate / sq. ft.	Negotiable
Expenses / sq. ft.	\$18.72*

*Not Including Utilities

- Excellent Frontage on the Bricks of the Pearl Street Pedestrian Mall
- Space Features Floor to Ceiling Windows for an Abundance of Natural Light
- 4,609 sq. ft. on Street Level with an Additional 1,134 sq. ft. of Mezzanine Space
- 47 ft. of Frontage Along the Bricks of Pearl Street
- Great Neighboring Tenants Including: Avanti, Postino, Illegal Pete's, Black Diamond, POC Sports, Montbell & Many Others
- Managed Locally by Unico Properties LLC - Known for Its Commitment to Delivering Top-Tier Customer Service & Building Quality



The information included has been obtained from sources believed reliable. While we do not doubt the accuracy of the information, it has not been verified and no guarantee, warranty, or representation is being made.



2305 Canyon Blvd, Suite 200, Boulder, CO 80302 - (303) 442-1040

© 2022 Gibbons-White, Inc.

1421 Pearl Street

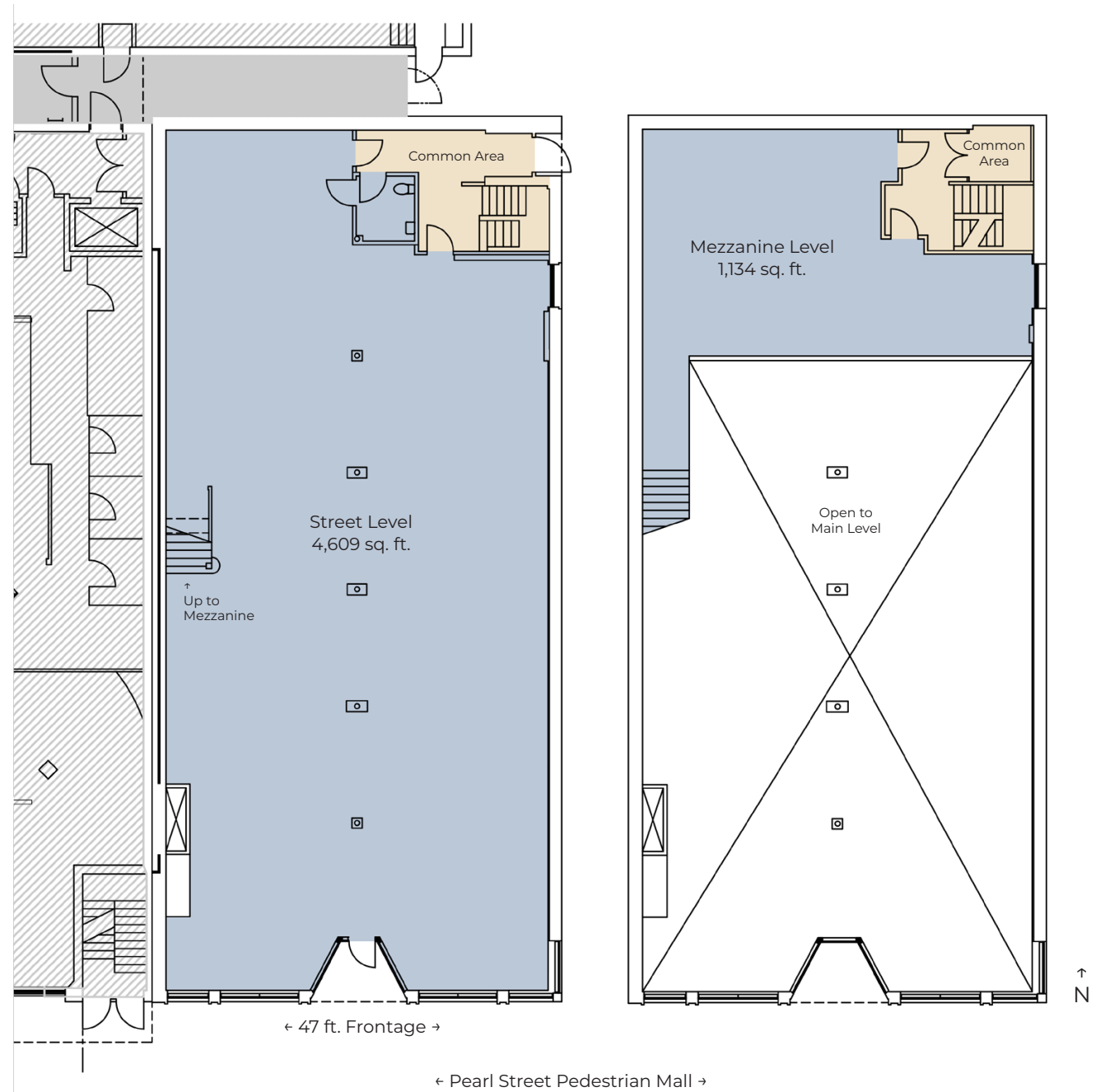

The information included has been obtained from sources believed reliable. While we do not doubt the accuracy of the information, it has not been verified and no guarantee, warranty, or representation is being made.



The information included has been obtained from sources believed reliable. While we do not doubt the accuracy of the information, it has not been verified and no guarantee, warranty, or representation is being made.



Avanti



Black Diamond

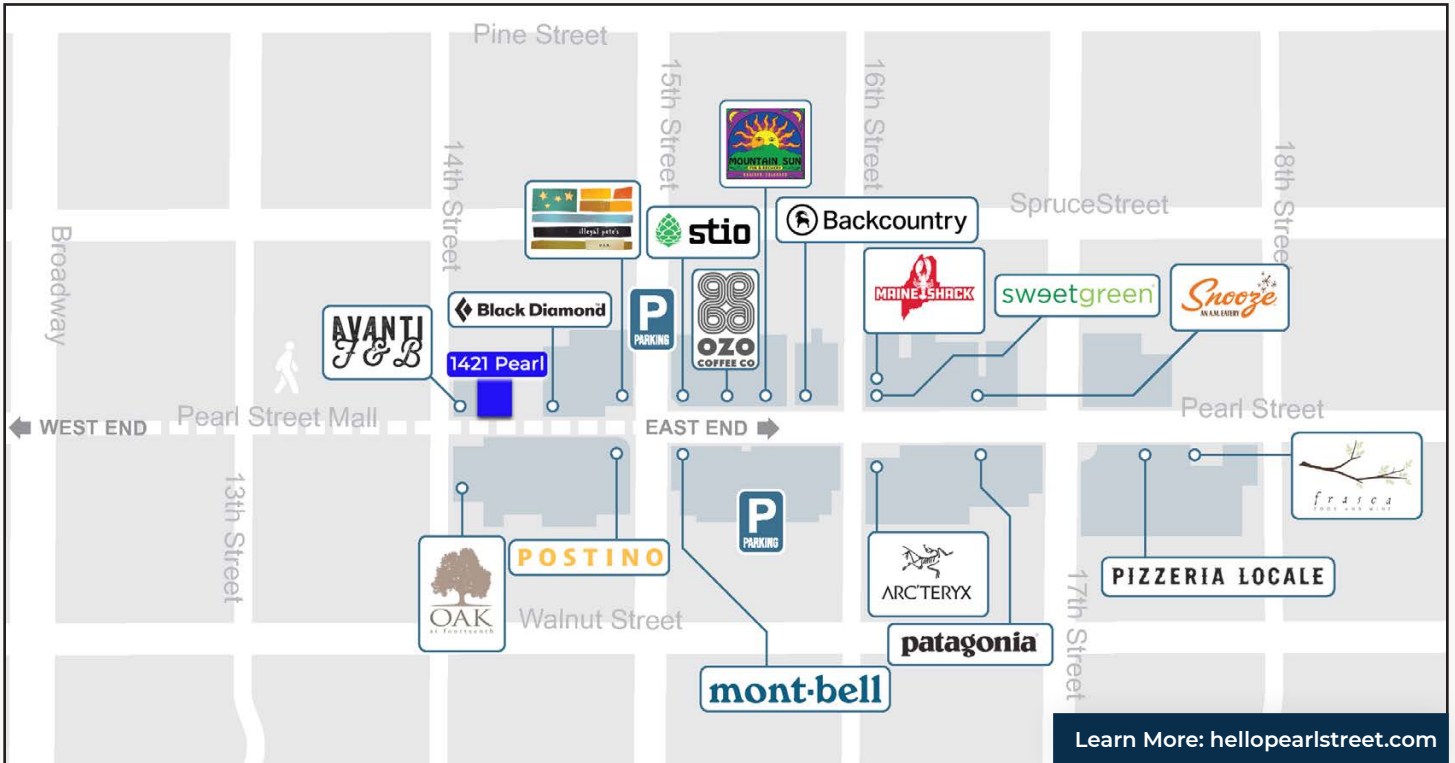

Snooze



Frasca



The information included has been obtained from sources believed reliable. While we do not doubt the accuracy of the information, it has not been verified and no guarantee, warranty, or representation is being made.